

PLAN PREPARED FOR:  
**THE LIVLAND GROUP**  
**BAILIE LANE**  
 VILLAGE OF SOUTH BLOOMING GROVE  
 ORANGE COUNTY, NEW YORK

**GENERAL NOTES**

1. VILLAGE OF SOUTH BLOOMING GROVE TAX MAP DESIGNATION: SEC. 219, BLK. 1, LOT 1.5.
2. THIS MAP IS BASED ON A FIELD SURVEY BY JOHN W. McCORD, L.S., JACKSON, NJ
3. PARCEL LOCATED IN THE ORI ZONING DISTRICT.
4. LOT AREA: 3,730,827 SQ. FT. (85.64 ACRE)
5. RECORD OWNER: BAILIE LANE ESTATES, 8 DEVAN DR. MONROE, NY 10950

**PROPOSED BULK REQUIREMENTS:**

MINIMUM FRONT YARD	40 FT. FROM CURB
MINIMUM SIDE YARD	20 FT.
MINIMUM BOTH SIDE YARDS	40 FT.
MINIMUM REAR YARD	40 FT.
MAXIMUM BUILDING HEIGHT	3 STORIES

**PROPOSED BUILDING(S) AREA**

264 UNITS  
 434 PARKING SPACES

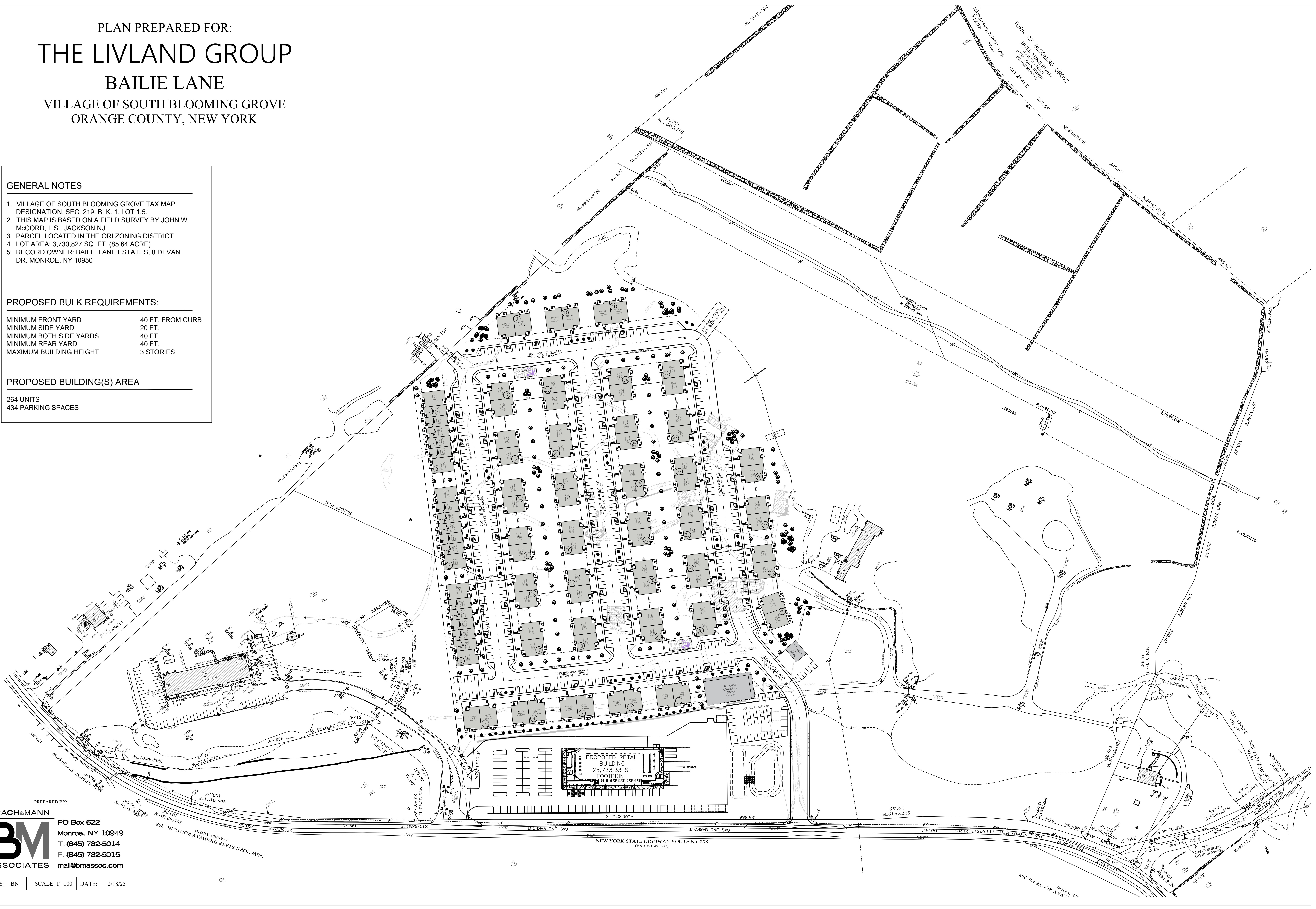

PREPARED BY:  
**BRACH&MANN**  
**BM** ASSOCIATES  
 PO Box 622  
 Monroe, NY 10949  
 T. (845) 782-5014  
 F. (845) 782-5015  
 mail@bmassoc.com